

# Survey Vessel

# Chartwell

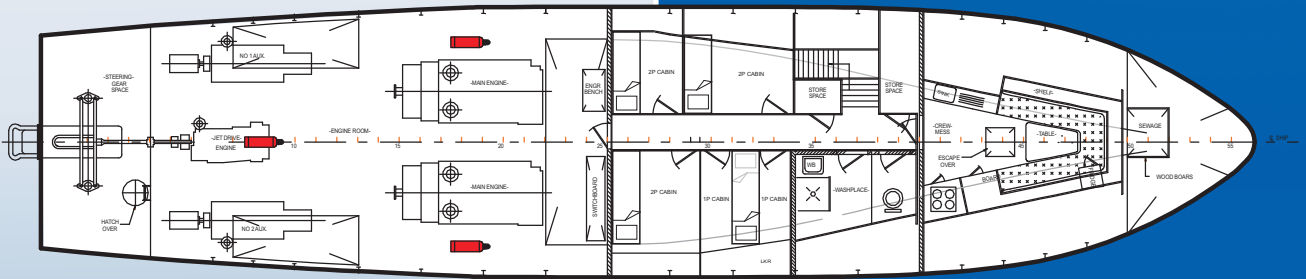

SV Chartwell is a 26.6m purpose built coastal survey vessel with comfortable overnight accommodation for 9 people in 3 double and 3 single cabins. The vessel has undergone a comprehensive re-fit, completed in spring 2009, and is equipped to remain at sea for up to 5 days with a full complement onboard. Chartwell provides a very economical and cost effective survey platform that is ideally suited to surveying sites that lie beyond the range of Osiris Projects smaller day vessels. The vessel uses her main engines for transit at up to 16 knots and her secondary, water jet propulsion system to drive the vessel at slow speed during survey operations and for station keeping.

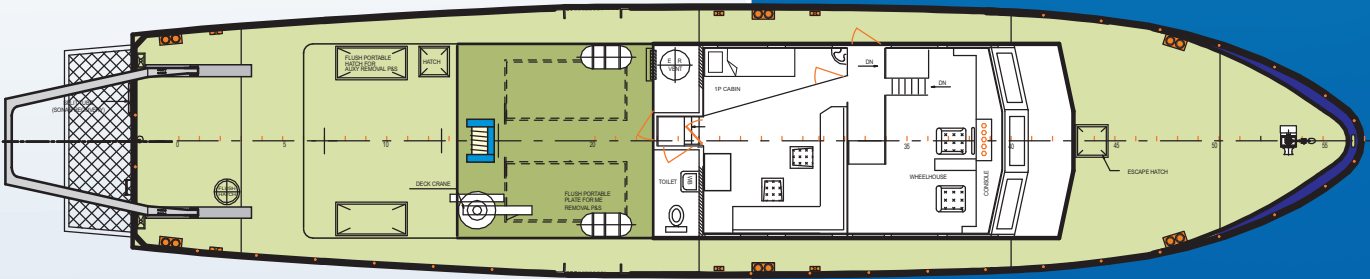
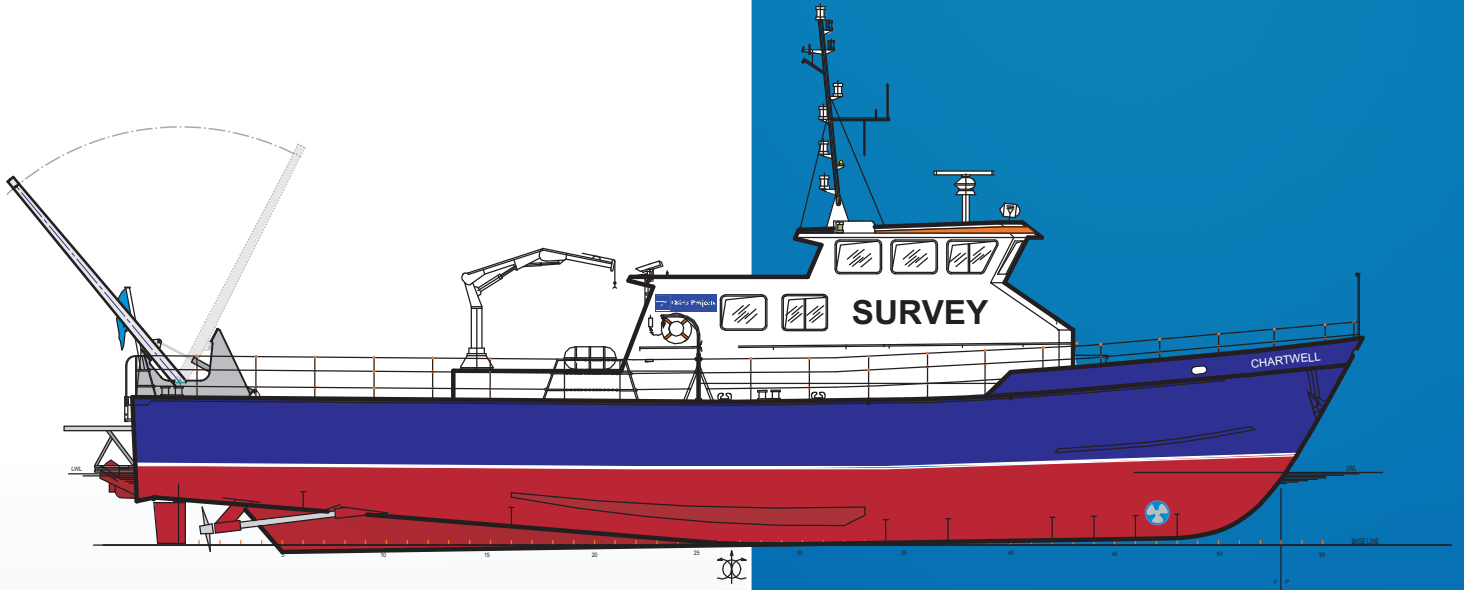

**Osiris Projects**

**Seabed Mapping & Coastal Survey**

[www.osirisprojects.co.uk](http://www.osirisprojects.co.uk) Tel: +44 (0) 151 328 1120  
enquiries@osirisprojects.co.uk Fax: +44 (0) 151 328 1139

<b>Builder:</b>	McTay Marine Limited – Wirral.	
<b>Launched:</b>	Originally launched in 1989 and completely re-fitted in 2009.	
<b>Length:</b>	26.60 Metres	
<b>Beam:</b>	5.90 Metres	
<b>Draught:</b>	2.10 Metres	
<b>Displacement:</b>	106 Tonnes	
<b>Cruising Speed:</b>	15 Knots (primary propulsion)	
<b>Survey Speed:</b>	0 to 8 Knots (secondary propulsion)	
<b>Fuel Capacity:</b>	10 Tonnes	
<b>Fresh Water:</b>	2.2 Tonnes	
<b>Range:</b>	750 Miles	
<b>Operating Code:</b>	MCA SCV Category 2 (60miles from safe haven). Category 1 (150 mile dispensation available for specified contract).	
<b>Main Engines:</b>	2 x MAN 2842 LE401 800h.p. rated continuous duty marine diesels with ZF 2000A hydraulic gearboxes driving conventional shafts and fixed pitch propellers.	
<b>Secondary Propulsion:</b>	Volvo Penta D122A 380h.p. rated continuous duty marine diesel driving PP170 water jet unit.	
<b>Thruster:</b>	Hydraulic 50 h.p. bow thruster with full proportional control.	
<b>A Frame:</b>	6m clear lift from deck with 1000kg safe working load.	
<b>Access Platform:</b>	Stern platform 1.5m x 4.5m approximately 1.0m above water level for easy deployment and recovery of towfish etc.	
<b>Sonar Winch:</b>	Hydraulic side scan sonar winch with remote control, Focal slip rings and electronic level wind. Capacity of 500m - 8mm armoured sonar cable. 1000kg line pull with 50m/min recovery speed.	
<b>Deck Crane:</b>	4 Tonne / m hydraulic crane with integrated winch.	
<b>Bridge:</b>	Modern fully instrumented bridge with Furuno NavNet systems including dual radar, dGPS chart plotter, AIS, dGPS gyro, Navtex, weather station, autopilot and dual frequency echo sounder.	
<b>Communications:</b>	Furuno Fleet Broadband satellite communications for voice, e-mail and internet. Wireless broadband facility and mobile broadband connectivity within mobile phone range. PC network and wireless network for both survey data and internet access. Networked camera system with 4 deck cameras and 5 internal cameras.	
<b>Survey Lab:</b>	Dedicated on-line survey lab with computer racking, power points, network points, dedicated UPS and work benches.	
<b>Accommodation:</b>	Three double cabins and three single cabins providing accommodation for a maximum of 9 people. Toilet on the main deck with a separate toilet and shower room / wet room below. Mess room with TV and fully equipped galley with seating for 6. Laundry facilities and supply capacity for approximately 5 days at sea.	



**Osiris Projects**

**Seabed Mapping & Coastal Survey**

www.osirisprojects.co.uk  
enquiries@osirisprojects.co.uk

Tel: +44 (0) 151 328 1120  
Fax: +44 (0) 151 328 1139